

MPT-21520 3/8" Reversible Air Drill

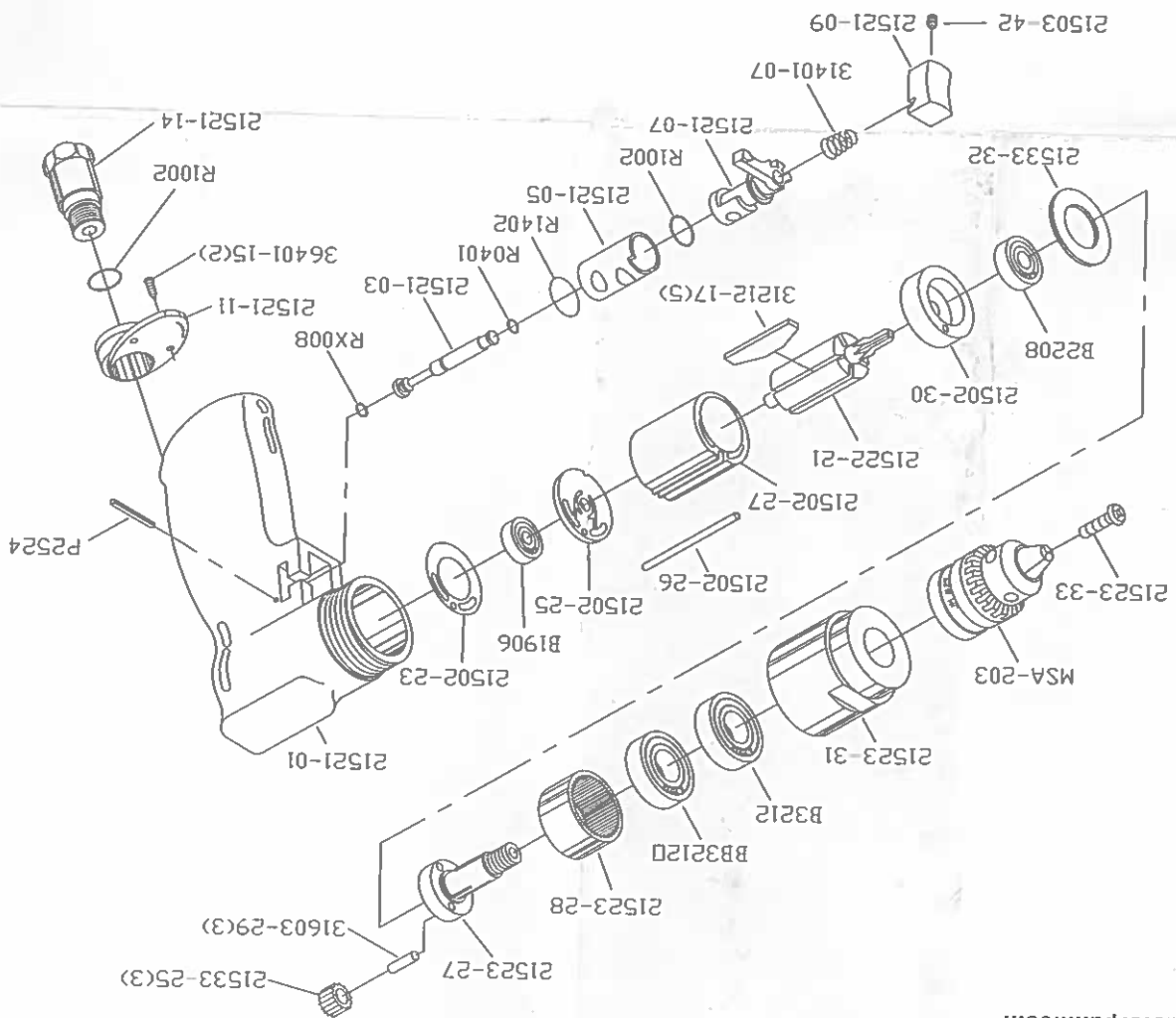

DESCRIPTION	PARTS NO.	DESCRIPTION	PARTS NO.
MOTOR HOUSING	21521-01	REAR END PLATE	21502-25
O RING	RX008	MOTOR PIN	21502-26
THROTTLE VALVE	21521-03	CYLINDER	21502-27
O RING	R0401	ROTOR	21522-21
O RING	R1402	ROTOR BLADE(S)	31212-17
REVERSE BUSHING	21521-05	FRONT END PLATE	21502-30
O RING	R1002	BEARING	B2208
REVERSE VALVE	21521-07	MOTOR WASHER	21533-32
VALVE SPRING	31401-07	PLANET GEAR (3)	21533-25
TRIGGER	21521-09	PLANET GEAR SPINDLE(3)	31603-29
SET SCREW	21503-42	PLANET GEAR SEAT	21523-27
EXHAUST SLEEVE	21521-11	INTERNAL GEAR	21523-28
CIRCLE OF SCREW (2)	36401-15	BEARING	BB32120
O RING	R1002	BEARING	B3212
INLET BUSHING	21521-14	CLAMP NUT	21523-31
SPRING PIN	P2524	CHUCK	MSA-203
MOTOR GASKET	21502-23	CHUCK SCREW	21523-33
BEARING	B1906	SK4 SPINNER WRENCH	WO318