

MPT21680 3/8" (2500RPM) Straight Air Drill

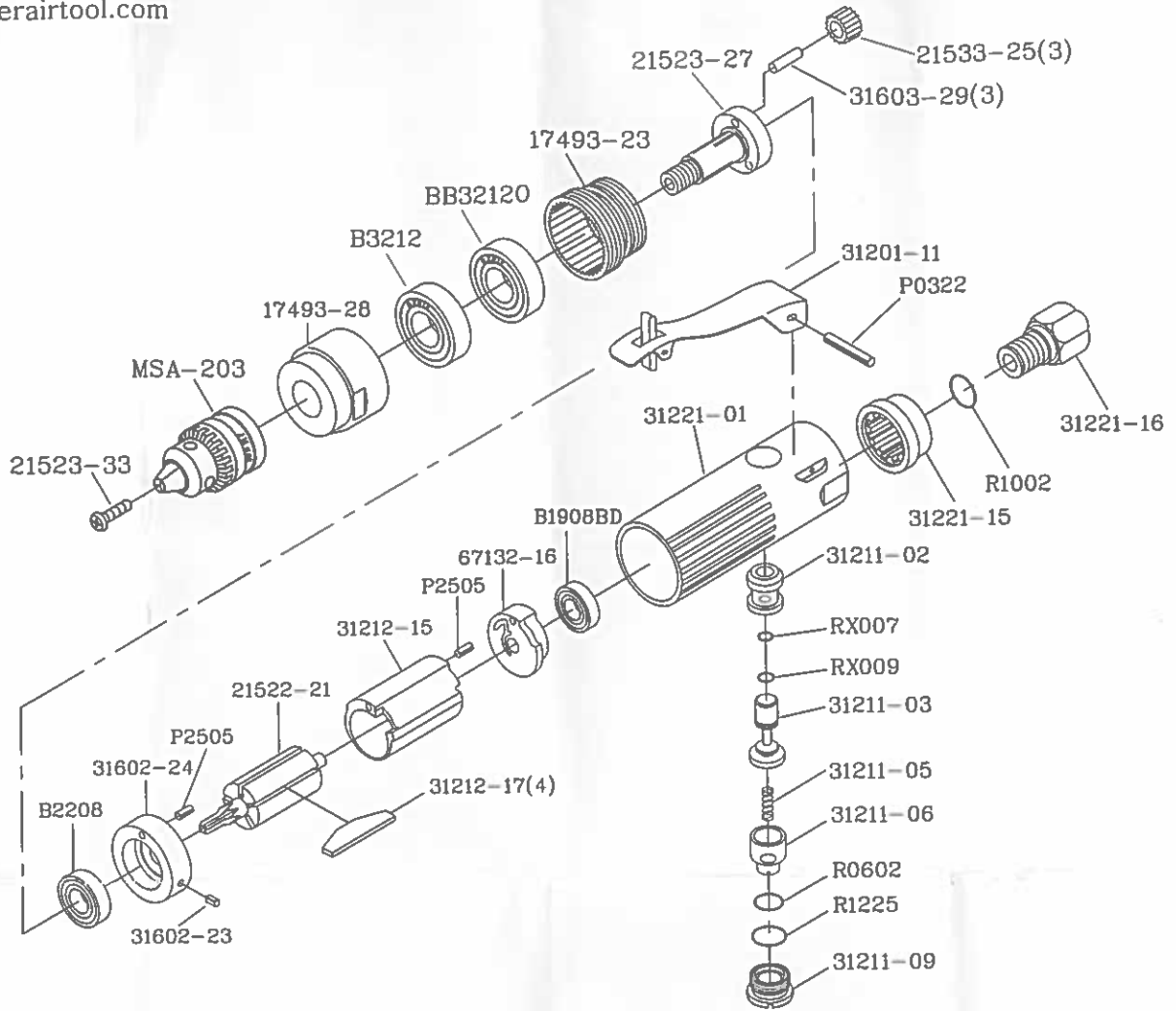

DESCRIPTION	PARTS NO	DESCRIPTION	PARTS NO
MOTOR HOUSING	31221-01	DOWL PIN(2)	P2505
BUSHING	31211-02	CYLINDER	31212-15
O RING	RX007	ROTOR	21522-21
O RING	RX009	ROTOR BLADE(4)	31212-17
THROTTLE VAVLE	31211-03	FRONT END PLATE	31602-24
SPRING	31211-05	ROLL PIN	31602-23
REGUILATER	31211-06	BALL BEARING	B2208
O RING	R0602	GEAR (3)	21533-25
O RING	R1225	GEAR PIN(3)	31603-29
VAVEL NUT	31211-09	PLANET GEAR SEAT	21523-27
VAVLE LEVER	31201-11	INTERNAL GEAR	17493-23
LEVER PIN	P0322	BALL BEARING	B3212
EXHAUST SLEEVE	31221-15	BALL BEARING	BB32120
O RING	R1002	CLAMP NUT	17493-28
AIR INLET	31221-16	CHUCK	MSA-203
BALL BEARING	B1908BD	CHUCK SCREW	21523-33
REAR END PLATE	67132-16	SK4 SPANNER WRENCH	WO318